

User Manual-Smart Cylinder

TTLOCK VERSION

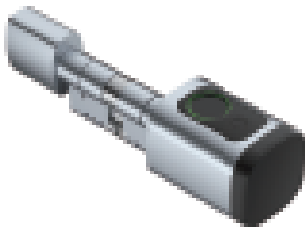

Smart your life!

Version 1.0 Edition V1

1 Packing Accessories

Please check the packing box and accessories when you got the item in hand.

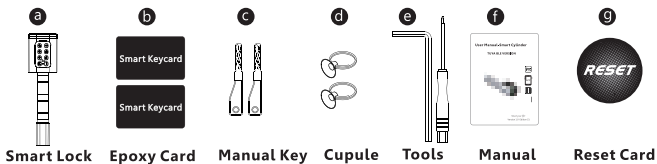

2 Product Specification

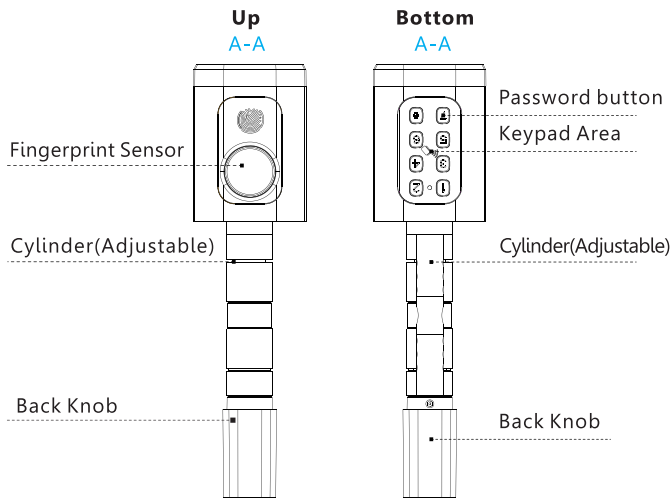

3 Reader View

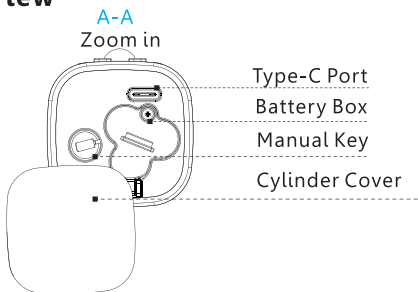

4 Dimension

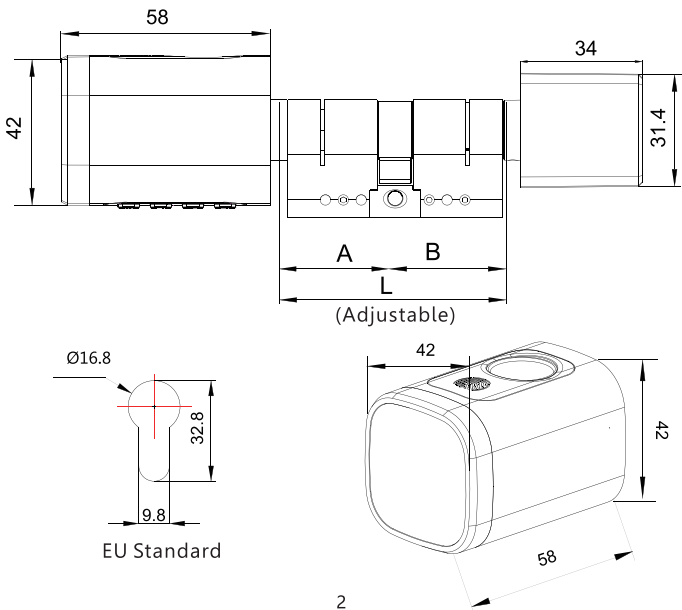

5 ACCESSORIES INSTALLATION

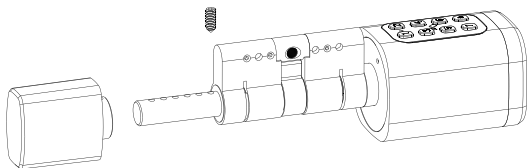

6 INSTALLATION STEPS

6.1 Please use the screw driver to take off the screw on the back knob position, refer the below Pic.1:

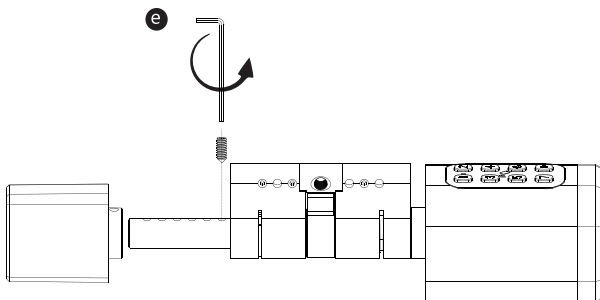

Pic.1

6.2 Please insert the cylinder to the existed lock and fix the cylinder with the long screw as picture 2.

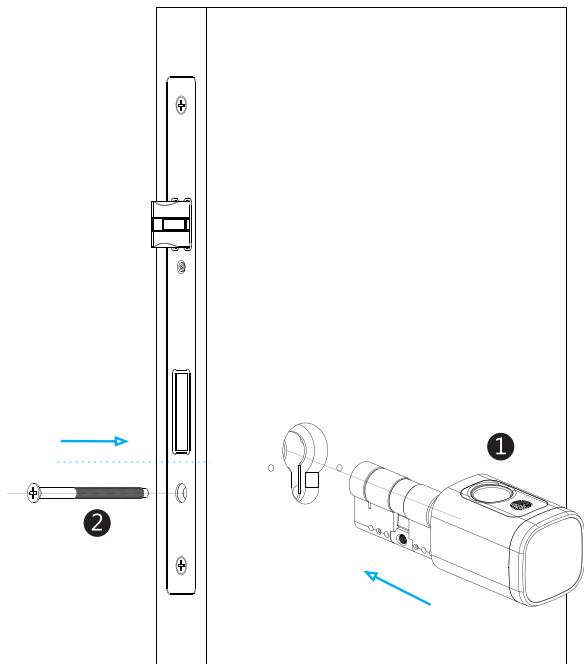

Pic.2

6.3 Please use the screw driver to fasten the screw on the back knob position, refer the below picture 3:

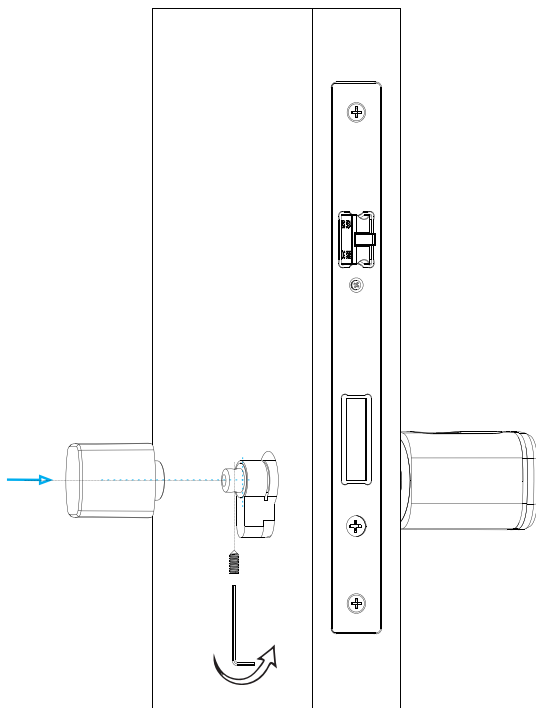

Pic.3

6.4 Please take off the reading knob cover with the magnet or sucker (included in our accessories bag), assemble 3xAAA battery, refer the below picture 4:

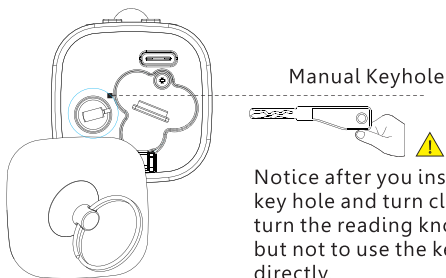
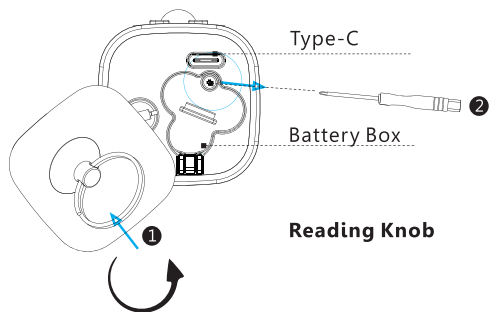

Pic.4

6.5 Please test with your fingerprint/password under the factory state, any fingerprint/password 123456# will unlock the door lock, refer to below picture 5:

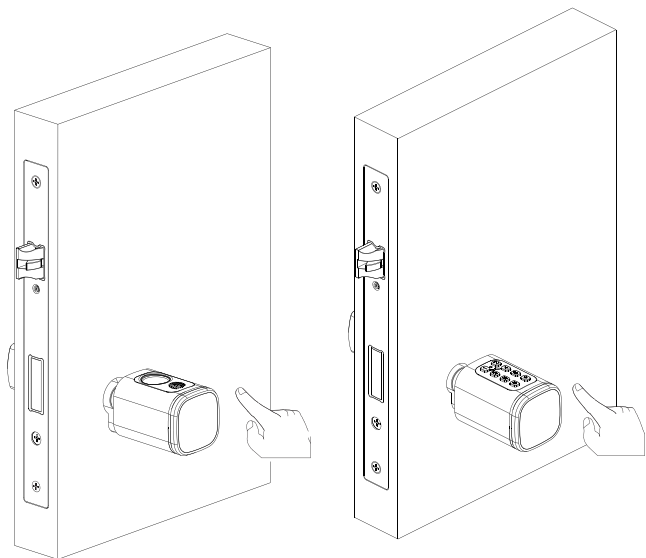

Fingerprint settings

Password settings

Pic.5

6.6 Please test the lock with key card after you configure the lock with TTlock APP(Refer to Part 6).

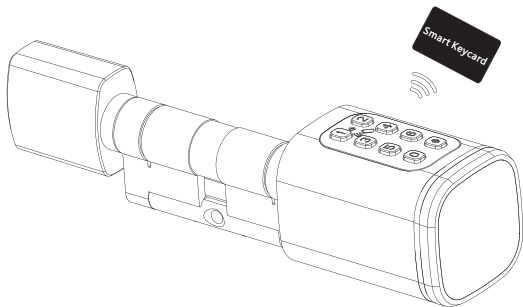

Notice the keycard or fingerprint can only be enrolled by the TTlock APP, so it is important to install this app in your mobile before starting daily use.

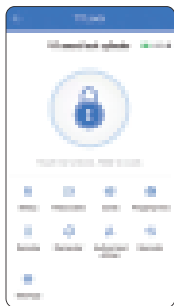

7 TTLOCK APP Settings

Please download the TTLOCK on Apple store or Google play. also you can scan the QR code below to download the APP directly.



7.1 Please register one account with your E-mail or mobile number.



6.1.1 Sign up and Register with mobile or Email

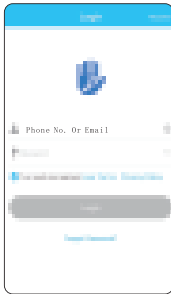

6.1.2 Enter mobile or mail Login with right password



6.1.3 You can reset your password

7.2 Configure the Lock

Please run the TTLOCK APP and click "Add LOCK" on the left side of the APP and follow steps to configure the lock.

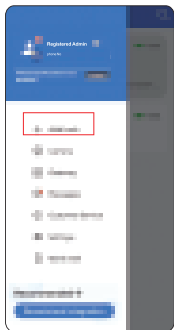

Step 1

Add Lock



Step 2

Choose "Door Lock"

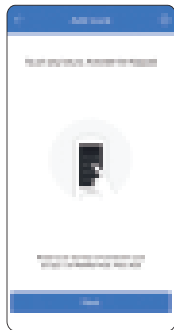

Step 3

Activate the keypad or fingerprint

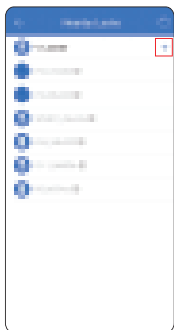

Step 4

Find the right lock and click "+"



Step 5

Successfully add the lock then rename it

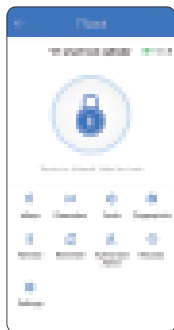

7.5 Enroll Pass-code

Click the "Passcodes" and generate different type pass-code. Set permanent / Timed / One-time / Custom / Recurring pass-code according to different using situation. If you want to delete all pass-code users, click the right top "Reset" to do it.

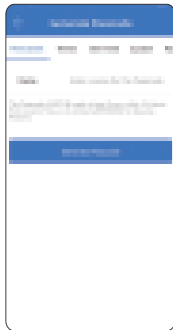
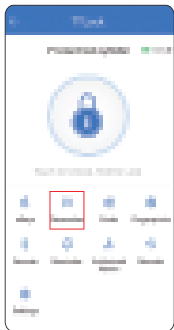

7.6 Enroll cards

Click the "Cards" to add a card user. You can set the card to be permanent / Timed / Recurring one. If you want to delete all card users, click the right top "Reset" to do it.

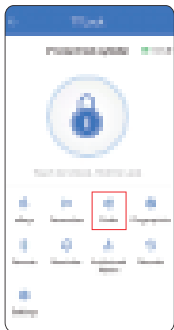

7.7 Enroll Fingerprints

Click the "Fingerprints" to add a fingerprint user. You can set the fingerprint to be permanent / Timed / Recurring one. If you want to delete all card users, click the right top "Reset" to do it.

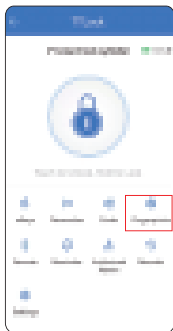

7.8 Enroll remote

Click the "Remote" to add a remote control. You can set the remote control to be permanent / Timed / Recurring one. If you want to delete all remote controls, click the right top "Reset" to do it.

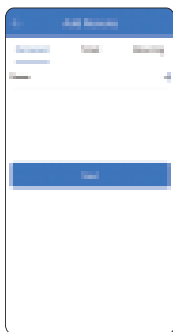
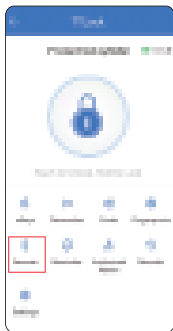

7.9 Reminder

You can set different scenario reminder according to different needs in daily life.

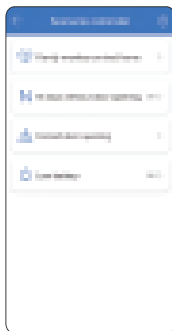
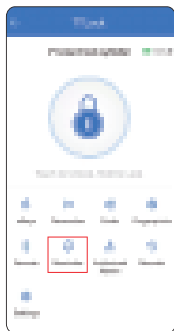

7.10 Authorized Admin

You can authorize other APP users to be the admin. The authorized admin will have majority permission to operate the lock. You can set Timed / Permanent authorized admin according to the real situation.

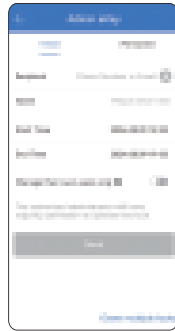
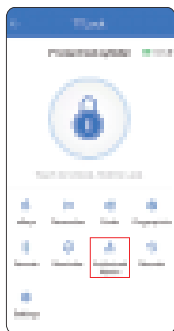

7.11 Records

You can check the unlocking records by clicking the "Records". You can also refresh / clear / export records on the top right.

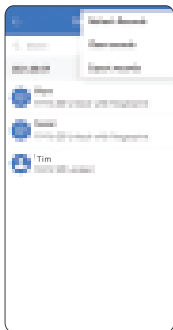
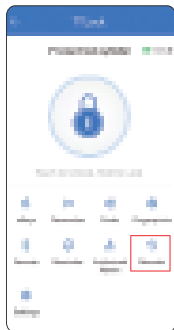

7.12 Settings

You can find some important settings of V1 smart cylinder by clicking "Settings".

- 1 **Basics:** find MAC/ID number / set the lock group / check or upload the admin Passcode. Please use the new pass-code at least once after uploading it.

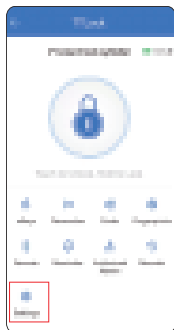

- 2 Passage Mode:** Turn on the passage mode and set the time period according to following steps.

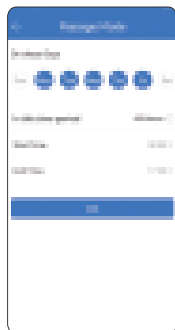

- 3 Auto lock:** you can set the auto lock time to be 10/15/30/60/Custom as following steps.

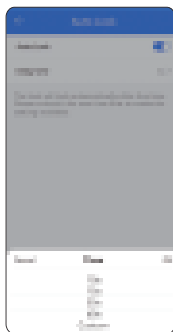
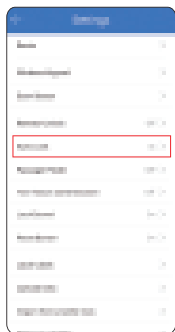

8. Reset the lock cylinder

There are two ways to reset lock.

- 1 Find in "Settings" bottom "Delete" and move forward to input your APP pass-code to complete the deleting.

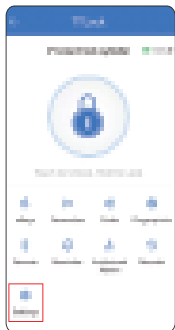

- 2 There is an one-to-one reset card for each smart cylinder. If the cylinder is mistakenly paired by other, you can use this reset card to reset the smart cylinder. Swipe the reset card on the reduction area till you hear one long beep which indicating the reset operation succeeds.

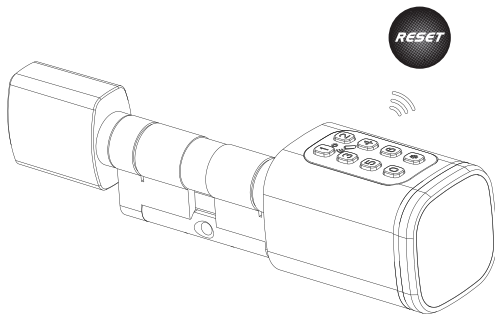

9.Remote unlocking

1 Remote Unlock Function(with Gateway)

The Wi-Fi gateway is a must to enable the remote unlock function, please refer the parameters below:

Model: **G2**

Dimension: 70x70x26mm

Network: Wi-Fi 2.4G

IEEE Standard: 802.11b/g/n

Power Interface: Type C USB

Power Input: DC5v/500mA

Light Status



When the gateway is power on:

- Light flashes alternately with red and blue;
- Stand by mode, ready for connection.
- Blue light: working mode
- Red light: network failure

Select the [Gateway]

8.1Pair the Gateway with APP

1. Activate the App on mobile



2. Press the button: ≡



3.



4. Select [G2]



5. Plug the gateway and power on it, when the light flashes alternately with red and blue



6. Press the "+"



7. Add Gateway



8. Select WiFi and enter password



9. Finish pairing gateway

⚠ Notice: If times out, please power on the gateway and try it again.

2 Remote unlock operation

Turn on the remote unlock function in "Settings-Remote unlock".

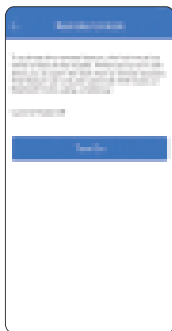
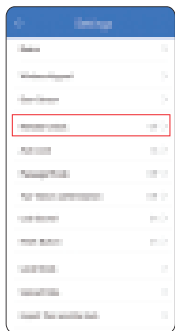

Add in gateway the V1 smart cylinder. The gateway will add the device in range which belongs to the same account.

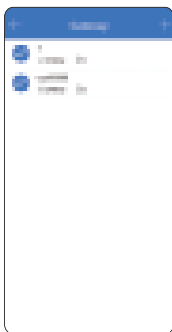
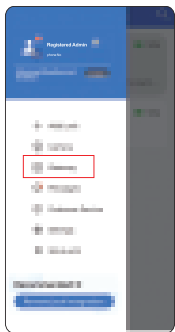

Remote unlock operation

Turn off the "Bluetooth" function in your phone then click the remote unlock button.

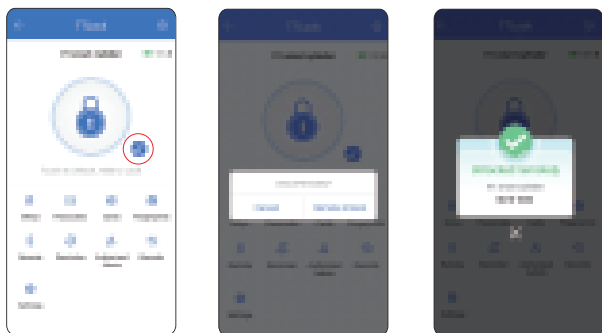

10.Sales and Service Terms

- Please read the manual carefully before use!
- Limited 1-year Electronic Warranty Limited Lifetime Mechanical and Finish Warranty.
- We offer a 1-year Limited Warranty on Electronic Parts and a limit lifetime for mechanical and finish defect warranty for this V1 smart cylinder under proper use for residential user. Proof of purchase and ownership is required to ensure that the lock cylinder is under effective warranty.
- Any error or question in our manual or sales term, please feel free to contact with us.
- We are free from any responsibility for any wrong operation or improper installation damage.
- We are not responsible for any damage caused by anthropic factor or inevitable reason and will not pay for the loss or maintain for free.Please check carefully our aftersale service terms.
- Please do not take apart the lock if you are not a technician in lock field. Or if it is a must, do it under the guidance of the technician.
- Notice: there might be tiny difference between the pictures for advertising and real product. Please note that real product shall prevail.

